



Comercializadora y Servicios



*Ingeniería y Proyectos Industriales*

*Componentes para Transportadores*



**SPLIT IDLER WHEELS ( INJECTION )**

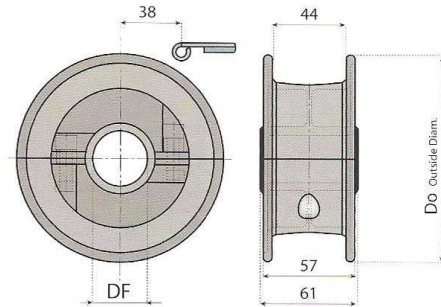

**FOR 812-815-881M-820**

编号 CODE	齿数 Z	外径 Do mm	孔径 DF mm
A04021-ID	21	129	25/30/35/40
A04023-ID	23	142	25/30/35/40
A04025-ID	25	154	25/30/35/40



**SPLIT IDLER WHEELS ( MACHINED )**

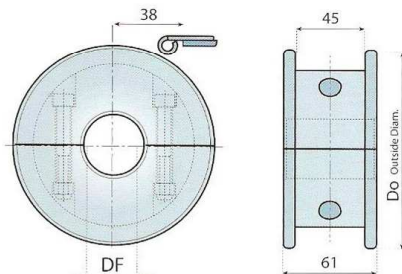

**FOR 812-815-881M-820**

编号 CODE	齿数 Z	外径 Do mm	孔径 DF mm
A06021-ID-1	21	129	25/30/35/40
A06023-ID-1	23	142	25/30/35/40
A06025-ID-1	25	154	25/30/35/40

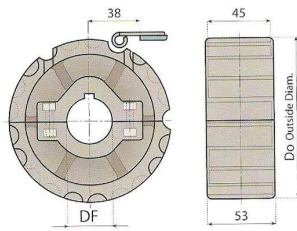

SPLIT SPROCKETS ( INJECTION )

**FOR 812-815-881M**

编号 CODE	齿数 Z	外径 Do mm	孔径 DF mm
A01021	21	129	25/30/35/40
A01023	23	142	25/30/35/40
A01025	25	154	25/30/35/40

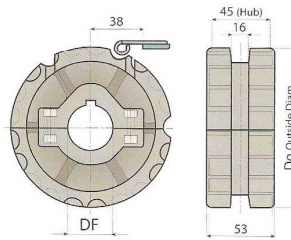

SPLIT SPROCKETS ( INJECTION )

**FOR 820-LBP831**

编号 CODE	齿数 Z	外径 Do mm	孔径 DF mm
G22021	21	129	25/30/35/40
G22023	23	142	25/30/35/40
G22025	25	154	25/30/35/40

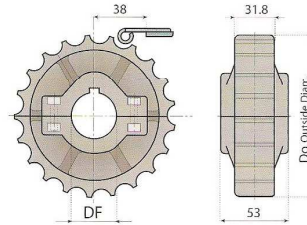

SPLIT SPROCKETS ( INJECTION )

**FOR 881BEVEL-881TAB**

编号 CODE	齿数 Z	外径 Do mm	孔径 DF mm
F19021	21	129	25/30/35/40
F19023	23	142	25/30/35/40
F19025	25	154	25/30/35/40

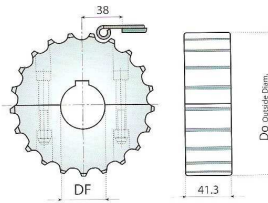

SPLIT SPROCKETS ( MACHINED )

**FOR 812-815-881M**

编号 CODE	齿数 Z	外径 Do mm	孔径 DF mm
A03021-1	21	129	25/30/35/40
A03023-1	23	142	25/30/35/40
A03025-1	25	154	25/30/35/40

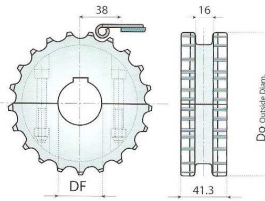

SPLIT SPROCKETS ( MACHINED )

**FOR 820-LBP831**

编号 CODE	齿数 Z	外径 Do mm	孔径 DF mm
G24021-1	21	129	25/30/35/40
G24023-1	23	142	25/30/35/40
G24025-1	25	154	25/30/35/40

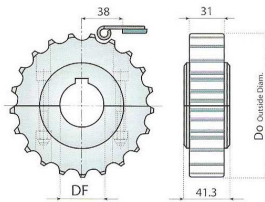

SPLIT SPROCKETS ( MACHINED )

**FOR 881BEVEL-881TAB**

编号 CODE	齿数 Z	外径 Do mm	孔径 DF mm
F20021-1	21	129	25/30/35/40
F20023-1	23	142	25/30/35/40
F20025-1	25	154	25/30/35/40



SPLIT SPROCKETS ( INJECTION )

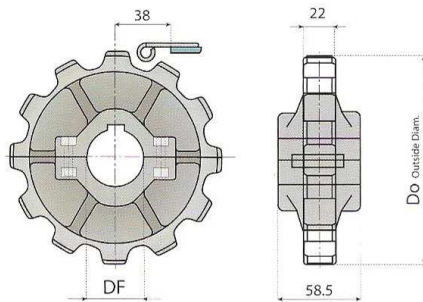

FOR 882BEVEL-882M-882TAB-LBP882TAB

编号 CODE	齿数 Z	外径 Do mm	孔径 DF mm
K37010	10	125	25/30/35/40
K37012	12	149	25/30/35/40



SPLIT SPROCKETS ( INJECTION )

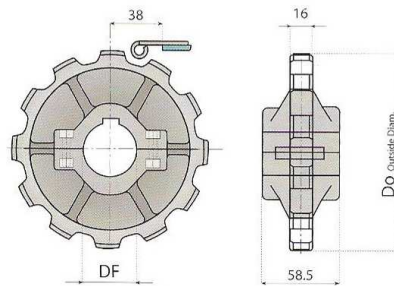

FOR 880-880M-880TAB-878TAB-880BS-RT880

编号 CODE	齿数 Z	外径 Do mm	孔径 DF mm
I32010	10	122	25/30/35/40
I32012	12	147	25/30/35/40



SPLIT SPROCKETS ( MACHINED )

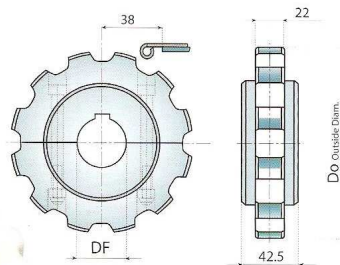

FOR 882BEVEL-882M-882TAB-LBP882TAB

编号 CODE	齿数 Z	外径 Do mm	孔径 DF mm
K38012-1	12	149	25/30/35/40

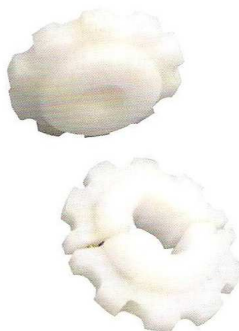

SPLIT SPROCKETS ( MACHINED )

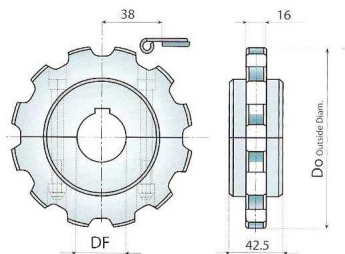

FOR 880-880M-880TAB-878TAB-880BS-RT880

编号 CODE	齿数 Z	外径 Do mm	孔径 DF mm
I33012-1	12	147	25/30/35/40

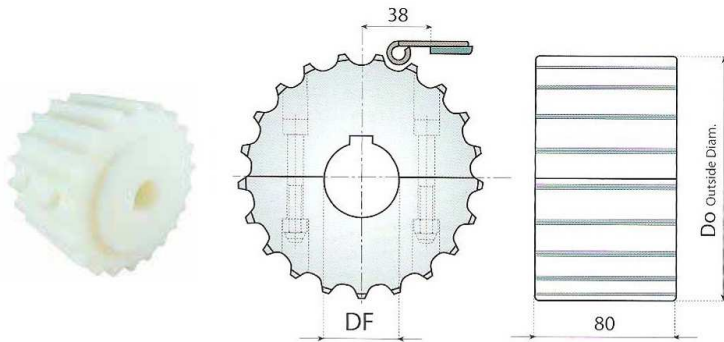

SPLIT SPROCKETS (MACHINED)

FOR 821-LBP821

编号 CODE	齿数 Z	外径 Do mm	孔径 DF mm
H29021-1	21	129	25/30/35/40
H29023-1	23	142	25/30/35/40
H29025-1	25	154	25/30/35/40

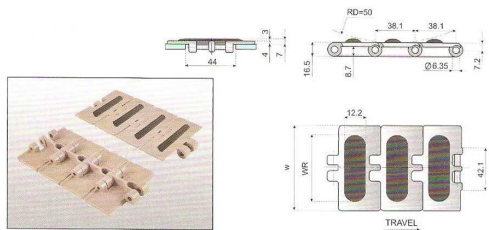

820G WITH RUBBER TOP

链号 Chain No.	宽度 Width ( W )		宽度 Width ( WR )	
	mm	inch.	mm	inch.
820 - K325G	82.6	3.25	63	2.48
820 - K400G	101.6	4.00	63	2.48
820 - K450G	114.3	4.50	63	2.48
820 - K600G	152.4	6.00	130	5.12
820 - K750G	190.5	7.5	168	6.62

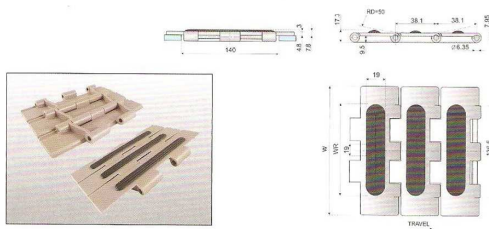

821G WITH RUBBER TOP

链号 Chain No.	宽度 Width ( W )		宽度 Width ( WR )	
	mm	inch.	mm	inch.
821 - K750G	190.5	7.5	168	6.62
821 - K1000G	254.0	10	105	7.68
821 - K1200G	304.8	12	245	9.65

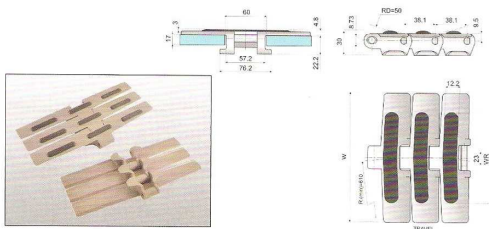

882TAB-G WITH RUBBER TOP

链号 Chain No.	宽度 Width ( W )		宽度 Width ( WR )	
	mm	inch.	mm	inch.
882TAB - K750G	190.5	7.5	168	6.62
882TAB - K1000G	254	10	195	7.68
882TAB - K1200G	304.8	12	245	9.65



**LF820 SINGLE HINGE STRAIGHT RUNNING**

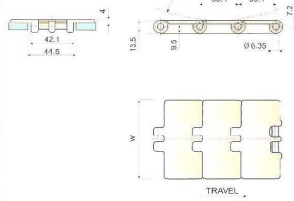
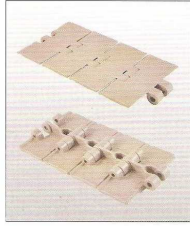

链号 Chain No.	宽度 Width (W)		重量 Weight	
	mm	inch	kg/m	lbs/ft
LF820 - K325	82.6	3.25	0.96	0.58
LF820 - K400	131.6	4.00	0.92	0.62
LF820 - K450	114.3	4.50	1.01	0.68
LF820 - K600	152.4	6.00	1.22	0.82
LF820 - K750	190.5	7.50	1.45	0.98

- Apply for all kinds of food industry, such as beverage, bottle, can and other conveyors.
- The longest distance: 12M
- Max. speed: lubricant: 90M/min dryness 60M/min
- Working load: 2250N
- Pin material: austenitic stainless steel
- Plate material: POM acetal (Temperature: -40 ~ 50°C)
- Packing: 10 feet = 3.048 M/box 26pcs/M

**LF821 DOUBLE HINGE STRAIGHT RUNNING**

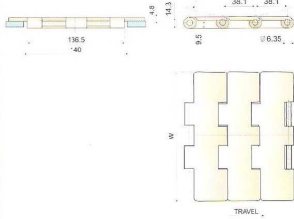
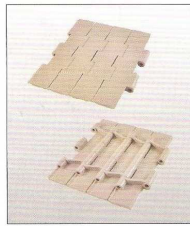

链号 Chain No.	宽度 Width (W)		重量 Weight	
	mm	inch	kg/m	lbs/ft
LF821 - K750	190.5	7.50	2.74	1.84
LF821 - K1000	254.0	10.00	3.21	2.16
LF821 - K1200	304.8	12.00	3.42	2.30

**LF880TAB SIDEFLEXING**

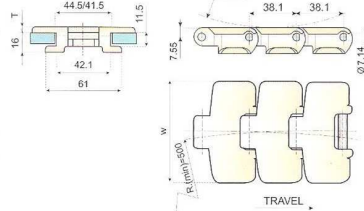
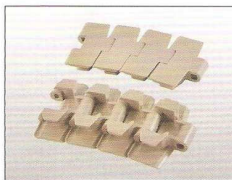

链号 Chain No.	宽度 Width (W)		重量 Weight	
	mm	inch	kg/m	lbs/ft
LF880TAB - K325	82.6	3.25	1.08	0.73
LF880TAB - K450	114.3	4.50	1.21	0.81

- beverage, bottle, can and other conveyors.
- The longest distance: 9M
- Max. speed: lubricant 90M/min dryness 60M/min
- Working load: 2250N

**LF880M MAGNETIC SIDEFLEXING**

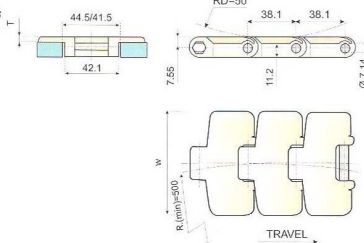
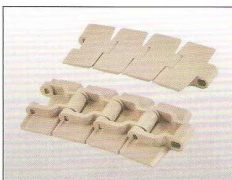

链号 Chain No.	宽度 Width (W)		重量 Weight	
	mm	inch	kg/m	lbs/ft
LF880M - K325	82.6	3.25	1.05	0.71
LF880M - K450	114.3	4.50	1.15	0.77

- Pin material: austenitic stainless steel
- Plate material: POM acetal (Temperature: -40 ~ 90°C)
- Packing: 10 feet = 3.048 M/box 26pcs/M

**LF882TAB SIDEFLEXING**

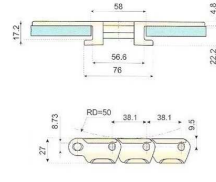
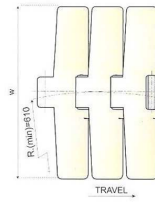
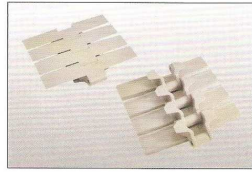

链号 Chain No.	宽度 Width (W)		重量 Weight	
	mm	inch	kg/m	lbs/ft
LF882TAB - K450	114.3	4.50	2.03	1.37
LF882TAB - K750	190.5	7.50	2.46	1.65
LF882TAB - K1000	254	10.00	2.87	1.93
LF882TAB - K1200	304.8	12.00	3.41	2.29

- Apply for all kinds of food industry, such as beverage, bottle, can and other conveyors.
- The longest distance: 12 M
- Max. speed: lubricant 90M/min dryness 60M/min
- Working load: 2250N
- Pin material: austenitic stainless steel
- Plate material: POM acetal (Temperature: -40 ~ 90°C)
- Packing: 10 feet = 3.048 M/box 26pcs/M

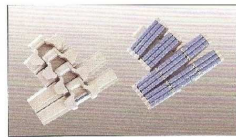

**LBP882TAB SIDEFLEXING**  
with low noise accumulation rollers

链号 Chain No.	宽度 Width (W)	
	mm	inch.
LBP882TAB - K375	95.3	3.75

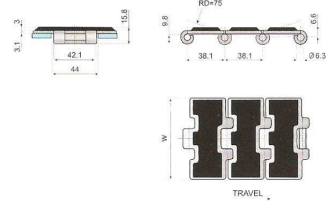
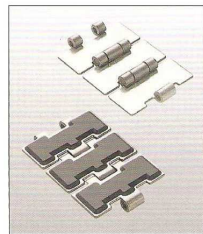
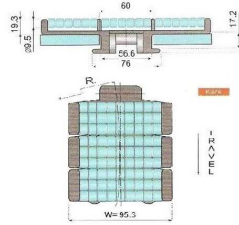
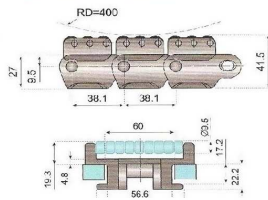

**SS812/815G WITH RUBBER TOP**

链号 Chain No.	宽度 Width (W)	
	mm	inch.
SS812/815 - K325G	82.6	3.25
SS812/815 - K450G	114.3	4.50
SS812/815 - K750G	190.5	7.50

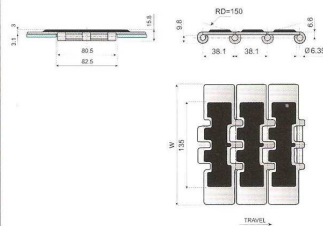
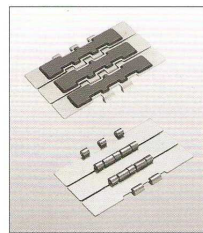

**SS802/805G WITH RUBBER TOP**

链号 Chain No.	宽度 Width (W)	
	mm	inch.
SS805 - K750G	190.5	7.50

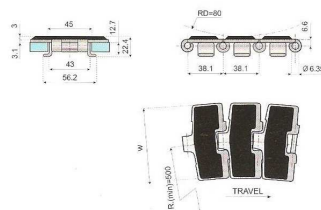
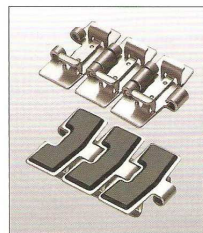

**SS881TAB-G WITH RUBBER TOP**

链号 Chain No.	宽度 Width (W)	
	mm	inch.
SS881TAB - K325G	82.6	3.25
SS881TAB - K450G	114.3	4.50
SS881TAB - K750G	190.5	7.50

**SS812/815 SINGLE HINGE STRAIGHT RUNNING**

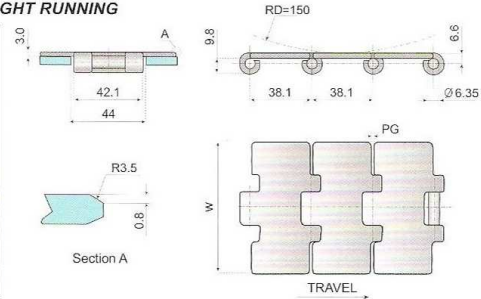

- Widely used in all kinds of conveyor of bottle and heavy load such as metal.
- Especially applied to beer industry.
- Corner tracks or turning disks can be selected for curved transportation.
- Suggestion: lubricant
- The longest distance: 12M
- Working load: 2250N
- Material: austenitic stainless steel (non-magnetic)
- Packing: 10 feet = 3.048 M/box 26pcs/M

链号 Chain No.	宽度 Width (W)		重量 Weight		链板间隙 Plate Gap (PG) mm
	mm	inch	kg/m	lbs/ft	
SS812/815 - K325	82.6	3.25	2.6	1.75	1.8
SS812/815 - K450	114.3	4.50	3.5	2.35	1.8
SS812/815 - K750	190.5	7.50	5.3	3.56	1.8

**SS881TAB SIDEFLEXING**

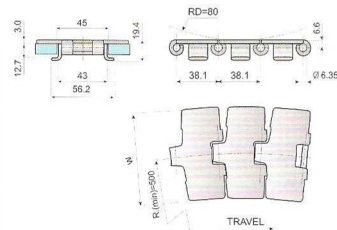
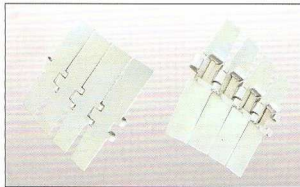

- Widely used in all kinds of conveyor of bottle and heavy load such as metal.
- Especially applied to beer industry.
- Corner tracks or turning disks can be selected for curved transportation.
- Suggestion: lubricant
- The longest distance: 12M
- Working load: 2250N
- Material: austenitic stainless steel (non-magnetic)
- Packing: 10 feet = 3.048 M/box 26pcs/M

链号 Chain No.	宽度 Width (W)		重量 Weight	
	mm	inch	kg/m	lbs/ft
SS881TAB - K325	82.6	3.25	3.1	2.09
SS881TAB - K450	114.3	4.50	3.6	2.42
SS881TAB - K750	190.5	7.50	5.3	3.56

**SS881M MAGNETIC SIDEFLEXING**

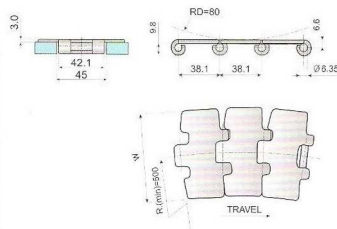
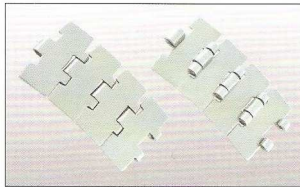

链号 Chain No.	宽度 Width (W)		重量 Weight	
	mm	inch	kg/m	lbs/ft
SS881M - K325	82.6	3.25	2.6	1.75
SS881M - K450	114.3	4.50	3.5	2.35
SS881M - K750	190.5	7.50	4.9	3.30

**D80 Articulated feet**

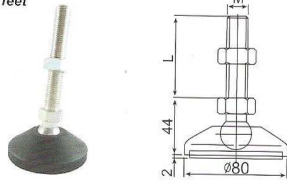

编号 Code -C / -SS	螺纹直径 (Dia.M)	螺纹长度 (Length L)
D80-1650	M16	50
D80-16100	M16	100
D80-16150	M16	150

Base: Reinforced Polyamide with Rubber Pad;  
Spindle and Nut: Carbon Steel Nickel Plated, or Stainless Steel;  
Max Load: 1200Kg.

**D100 Articulated feet**

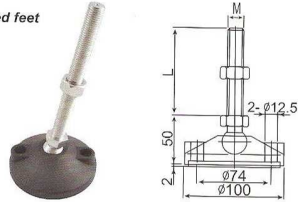

编号 Code -C / -SS	螺纹直径 (Dia.M)	螺纹长度 (Length L)
D100-1650	M16	50
D100-16100	M16	100
D100-16150	M16	150

Base: Reinforced Polyamide with Rubber Pad;  
Spindle and Nut: Carbon Steel Nickel Plated, or Stainless Steel;  
Max Load: 1500Kg.

**FD100 Fixed feet**

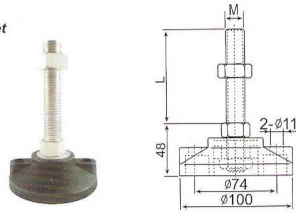

编号 Code -C / -SS	螺纹直径 (Dia.M)	螺纹长度 (Length L)
FD100-16100	M16	100

Base: Reinforced Polyamide;  
Spindle and Nut: Carbon Steel Nickel Plated, or Stainless Steel;  
Max Load: 1500Kg.

**MD100 Metal Articulated feet**

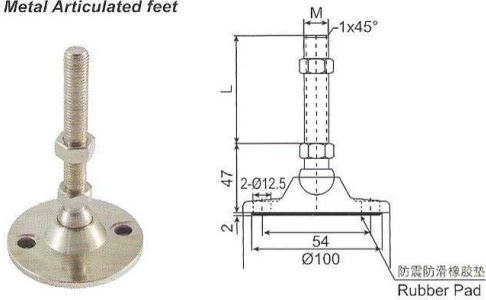

编号 Code -C / -SS	螺纹直径 (Dia.M)	螺纹长度 (Length L)
MD100-1650	M16	50
MD100-16100	M16	100
MD100-16150	M16	150

Base, Spindle and Nut: Carbon Steel Nickel Plated, or Stainless Steel;  
Max Load: 4000Kg.



**N109 Threaded Tube Ends For Square Tube**

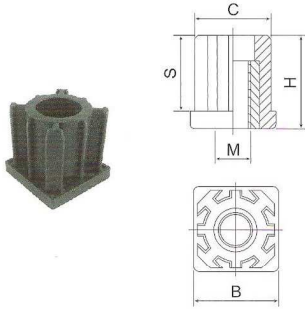

编号 Code	内螺纹 M (Dia. M)	外形尺寸 Dimension				方管 Square Tube		
		B	C	H	S	外径 (ØEXT.)	内径 (ØINT.)	壁厚 Thickness
N109-B40x2-M16	M16	40	36.5	43	35	40	36	2
N109-B50x2-M16	M16	50	46.5	55	44	50	46	2

Material: Reinforced Polyamide, Threaded Bushing in Brass.

**N110 Threaded Tube Ends For Round Tube**

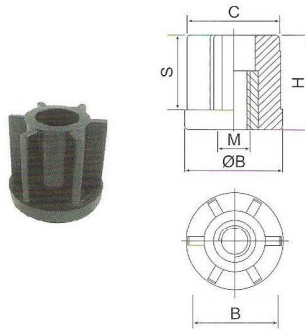

编号 Code	内螺纹 M (Dia. M)	外形尺寸 Dimension				圆管 Round Tube		
		B	C	H	S	外径 (ØEXT.)	内径 (ØINT.)	壁厚 Thickness
N110-B50x2-M16	M16	50	46.5	42	34	50	46	2

Material: Reinforced Polyamide, Threaded Bushing in Brass.

**N101 Support Bases (Tripods)**



编号 Code	孔径 (ØDF) mm	重量 Weight
N101 - 50.9	50.9	1.380kg

Material: Reinforced Polyamide, with SS Setscrews.

**N102 Support Bases (Bipods)**

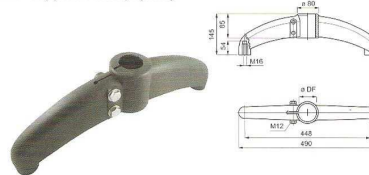

编号 Code	孔径 (ØDF) mm	重量 Weight
N102 - 50.9	50.9	1.070kg

Material: Reinforced Polyamide, with SS Setscrews.

**N103 Support Bases (Bipods 180° with joint)**

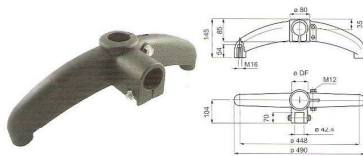

编号 Code	孔径 (ØDF) mm	重量 Weight
N103 - 50.9	50.9	1.270kg

Material: Reinforced Polyamide, with SS Setscrews.

**N104 Support Bases (Bipods 120° with joint)**



编号 Code	孔径 (ØDF) mm	重量 Weight
N104 - 50.9	50.9	1.285kg

Material: Reinforced Polyamide, with SS Setscrews.

**N242 Side Mounting Top Brackets**

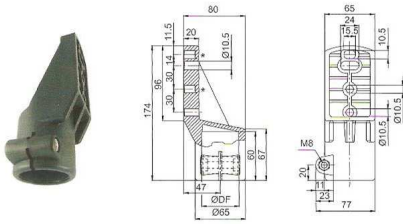

编号 Code	ØDF mm	重量 Weight
N242-50.9	50.9	0.32kg

Material: Reinforced Polyamide, with SS Setscrews.

**N245 Side Mounting Top Brackets**

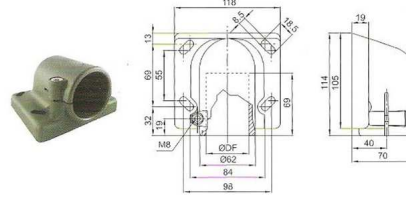

编号 Code	ØDF mm	重量 Weight
N245-48.3	48.3	0.34kg

Material: Reinforced Polyamide, with SS Setscrews.

**N251 Frame Supports**

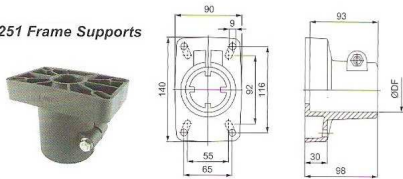

编号 Code	ØDF mm	重量 Weight
N251-50.9	50.9	0.40kg

Material: Reinforced Polyamide, with SS Setscrews.

**N253 Frame Support**

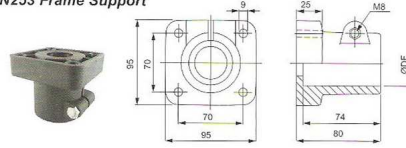

编号 Code	ØDF mm	重量 Weight
N253-50.9	50.9	0.25kg

Material: Reinforced Polyamide, with SS Setscrews.

**N219 Single Clamps for Round Profile Guides**

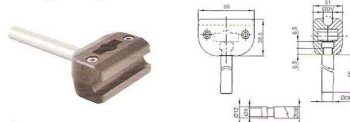

编号 Code	ØDV mm	ØDE mm	重量 Weight
N219-12x12	12	12	0.13kg

Material: Reinforced Polyamide, with SS Setscrews,  
Adjusting Rods in Stainless Steel.

**N208 Single Clamps for Round Profile Guides**

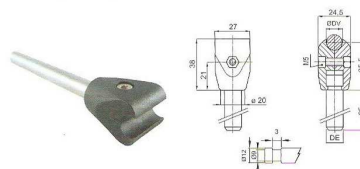

编号 Code	ØDV mm	ØDE mm	重量 Weight
N208-12x12	12	12	0.12kg

Material: Reinforced Polyamide, with SS Setscrews,  
Adjusting Rods in Stainless Steel.

**N229A Double Clamps for Round Profile Guides**

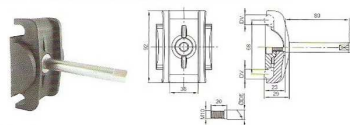

编号 Code	ØDV mm	ØDE mm	重量 Weight
N229A-12x12	12	12	0.20kg

Material: Reinforced Polyamide, with SS Setscrews,  
Adjusting Rods in Stainless Steel.

**N210 Single Clamps for Round Profile Guides**

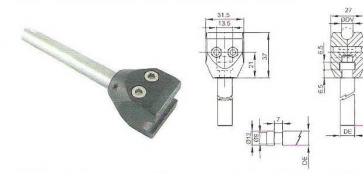

编号 Code	ØDV mm	ØDE mm	重量 Weight
N210-19x19	19	19	0.12kg

Material: Reinforced Polyamide, with SS Setscrews,  
Adjusting Rods in Stainless Steel.

**N226 Single Clamps for Conical Side Guides**

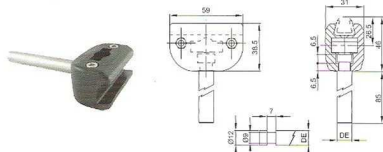

编号 Code	ØDE mm	重量 Weight
N226-12	12	0.13kg

Material: Reinforced Polyamide, with SS Setscrews,  
Adjusting Rods in Stainless Steel.

**N209 Single Clamps for Conical Side Guides**

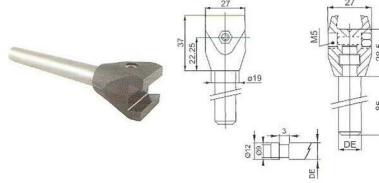

编号 Code	ØDE mm	重量 Weight
N209-12	12	0.12kg

Material: Reinforced Polyamide, with SS Setscrews,  
Adjusting Rods in Stainless Steel.

**N231A Double Clamps for Conical Side Guides**

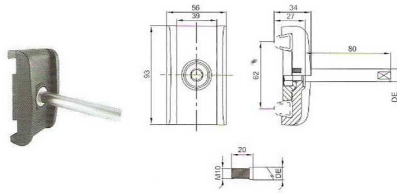

编号 Code	ØDE mm	重量 Weight
N231A-12	12	0.18kg

Material: Reinforced Polyamide, with SS Setscrews,  
Adjusting Rods in Stainless Steel.

**N216 Single Clamps for Conical Side Guides**

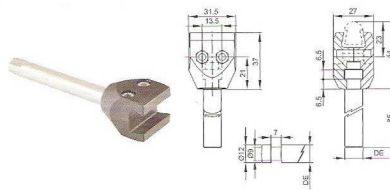

编号 Code	ØDE mm	重量 Weight
N216-12	12	0.12kg

Material: Reinforced Polyamide, with SS Setscrews,  
Adjusting Rods in Stainless Steel.

**N113 Split Shaft Collars for Round Shaft**

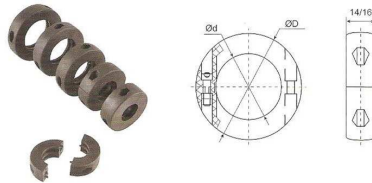

编号 Code	Ød (mm)	ØD (mm)	重量 Weight
N113 - 25	25	49	0.025kg
N113 - 30	30	54	0.030kg
N113 - 35	35	60	0.033kg
N113 - 40	40	65	0.036kg

Material: Reinforced Polyamide, with SS Setscrews.

**N203 T-Clamps**

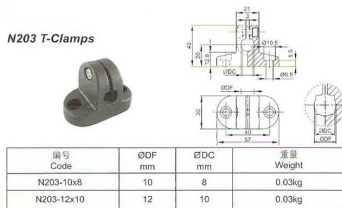

编号 Code	ØDF mm	ØDC mm	重量 Weight
N203-10x8	10	8	0.02kg
N203-12x10	12	10	0.03kg

Material: Reinforced Polyamide, with SS Setscrews.

**N204 T-Clamps**

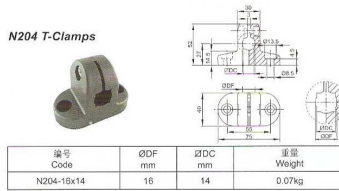

编号 Code	ØDF mm	ØDC mm	重量 Weight
N204-16x14	16	14	0.07kg

Material: Reinforced Polyamide, with SS Setscrews.

**N201 Cross Clamps**

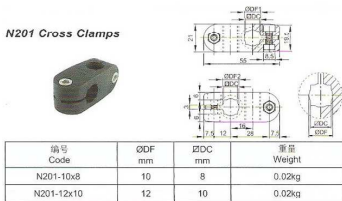

编号 Code	ØDF mm	ØDC mm	重量 Weight
N201-10x8	10	8	0.02kg
N201-12x10	12	10	0.02kg

Material: Reinforced Polyamide, with SS Setscrews.

**N202 Cross Clamps**

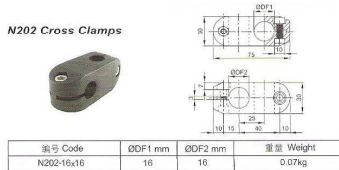

编号 Code	ØDF1 mm	ØDF2 mm	重量 Weight
N202-16x16	16	16	0.07kg

Material: Reinforced Polyamide, with SS Setscrews.

**N206 Sensor Clamps**

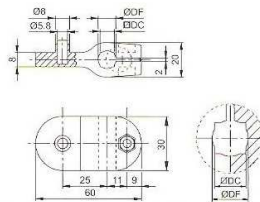

编号 Code	ØDF mm	ØDC mm	重量 Weight
N206-12x10	12	10	0.02kg

Material: Reinforced Polyamide, with SS Setscrews.

**N207 Sensor Clamps**

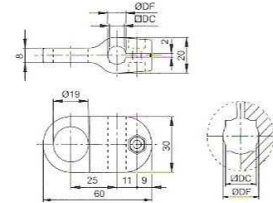

编号 Code	ØDF mm	ØDC mm	重量 Weight
N207-12x10	12	10	0.02kg

Material: Reinforced Polyamide, with SS Setscrews.

**N250 Connecting Joints**

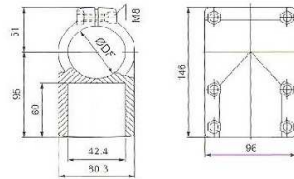

编号 Code	ØDF mm	重量 Weight
N250-50.9	50.9	∅40kg

Material: Reinforced Polyamide, with SS Setscrews.

**P815**

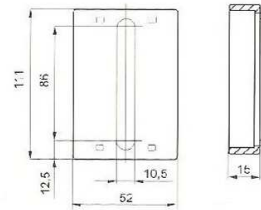

Material: Reinforced Polyamide.

**N248 Square Bore Cross Joints**

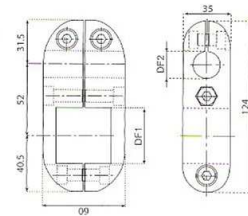

编号 Code	ØDF1 mm	ØDF2 mm	重量 Weight
N248-40x16	40	16	0.21kg

Material: Reinforced Polyamide, with SS Setscrews.

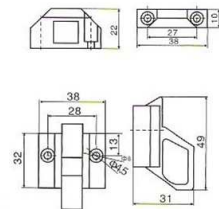

Type  
Latch lock for door

Material: Reinforced Polyamide

**N233 Clamps for Side Guides**

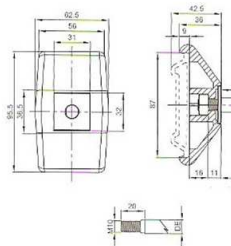

编号 Code	ØDE mm	重量 Weight
N233-12	12	0.16kg

Material: Reinforced Polyamide, with SS Setscrews,  
Adjusting Rods in Stainless Steel.



**N239 Side Guide Brackets**

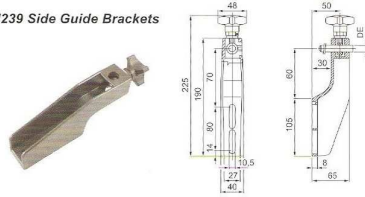

编号 Code	ØDE mm	重量 Weight
N239-14	14	0.23kg

Material: Reinforced Polyamide, with SS Setscrews.

**N238 Side Guide Brackets**

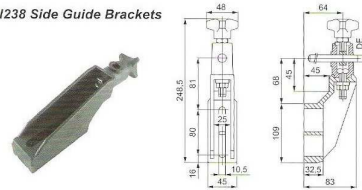

编号 Code	ØDE mm	重量 Weight
N238-14	14	0.30kg

Material: Reinforced Polyamide, with SS Setscrews.

**N240 Side Guide Brackets**

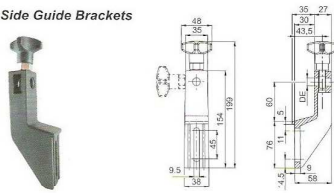

编号 Code	ØDE mm	重量 Weight
N240-14	14	0.20kg

Material: Reinforced Polyamide, with SS Setscrews.

**SS Brackets Articulated Group**

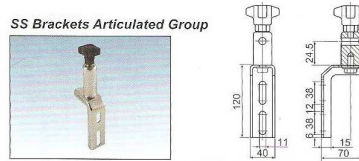

编号 Code	尺寸 Size	重量 Weight
N803	70*120*40	0.449kg

**N237A Short Adjustable Heads**

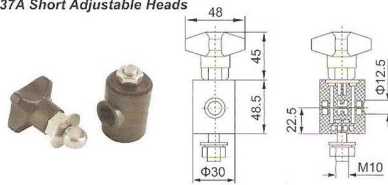

编号 Code	材质 Material	重量 Weight
N237A	增强尼龙, 吊环, 螺栓, 螺母及垫片均为不锈钢 Reinforced Polyamide, Eyebolt, Screw, Nut and Washer in Stainless Steel	0.140kg

**N237B Long Adjustable Heads**

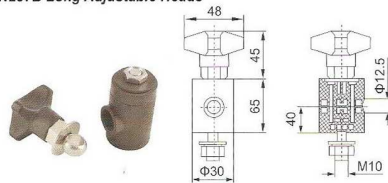

编号 Code	材质 Material	重量 Weight
N237B	增强尼龙, 吊环, 螺栓, 螺母及垫片均为不锈钢 Reinforced Polyamide, Eyebolt, Screw, Nut and Washer in Stainless Steel	0.143kg

**N237D Copper Adjustable Heads**

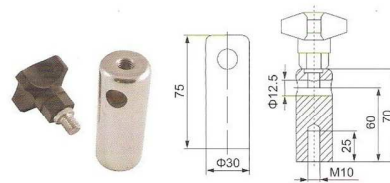

编号 Code	材质 Material	重量 Weight
N237D - A	不锈钢 Stainless Steel	0.385kg

**N234A Knobs**

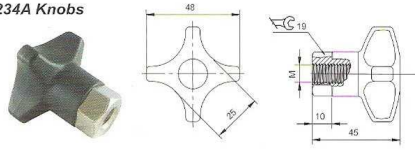

编号 Code	M	重量 Weight
N234A-M8	8	0.09kg
N234A-M10	10	0.09kg

Material: Reinforced Polyamide, Hexagonal Insert in Nickel Plated Brass or Stainless Steel.

**N236 Knobs**



编号 Code	D	d	H	h	di	重量 Weight
N236-30-M5	30mm	M5	21	11	17	0.014kg
N236-40-M6	40mm	M6	25	15	19.5	0.018kg
N236-40-M8	40mm	M8	25	15	19.5	0.020kg
N236-45-M8	45mm	M8	37	19	21	0.025kg
N236-45-M10	45mm	M10	37	19	21	0.025kg

Material: Reinforced Polyamide, with Brass Insert.

**N235A Knobs**



编号 Code	D	d	L	H	h	di	重量 Weight
N235A-45-M10x25	45mm	M10	25	32	19	21	0.050kg

Material: Reinforced Polyamide, Insert in Nickel Plated Brass.

**Small Adjustable Handles**

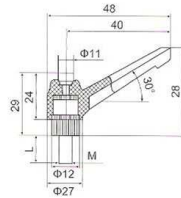
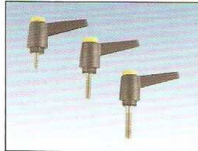

编号 Code	螺牙 Screw	手柄颜色 Handle Colour	重量 Weight
N-H6x20	M6x20	黑色 Black	0.030kg
N-H6x25	M6x25	黑色 Black	0.030kg

**Large Adjustable Handles**

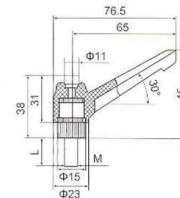
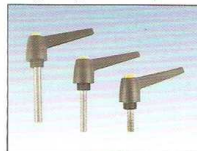

编号 Code	螺牙 Screw	手柄颜色 Handle Colour	重量 Weight
N-H8x20	M8x20	黑色 Black	0.035kg
N-H8x30	M8x30		0.040kg
N-H8x50	M8x50		0.050kg
N-H10x30	M10x30		0.056kg

**Small Adjustable Handles**

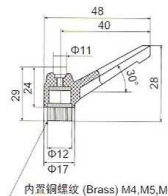

内置铜螺纹 (Brass) M4, M5, M6

编号 Code	螺牙 Screw	手柄颜色 Handle Colour	重量 Weight
N-H-M4	M4	黑色 Black	0.020kg
N-H-M5	M5		0.025kg
N-H-M6	M6		0.030kg

**Large Adjustable Handles**

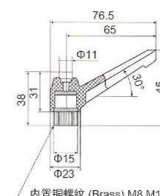

内置铜螺纹 (Brass) M8, M10

编号 Code	螺牙 Screw	手柄颜色 Handle Colour	重量 Weight
N-H-M8	M8	黑色 Black	0.030kg
N-H-M10	M10		0.040kg

**Small Handles**

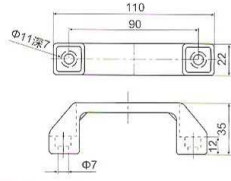

编号 Code	螺牙 Screw	重量 Weight
N-H90	None	0.04kg

**Middle Handles**

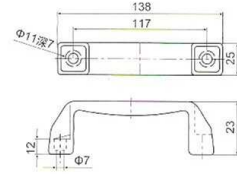

编号 Code	螺牙 Screw	重量 Weight
N-H117	None	0.06kg

**Middle Handles**

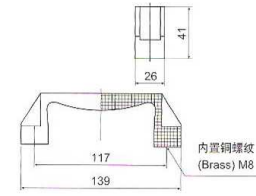

编号 Code	螺牙 Screw	重量 Weight
N-H117-M8	M8	0.07kg

**Large Handles**

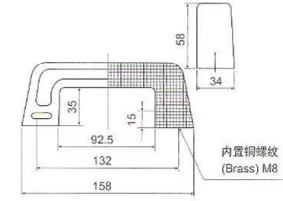

编号 Code	螺牙 Screw	重量 Weight
N-H132-M8	M8	0.120kg

**N309A Hinges**

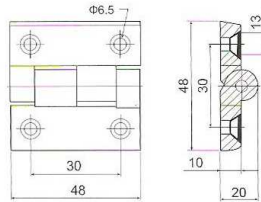
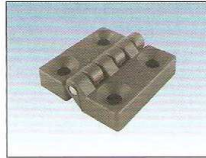

编号 Code	孔径 $\Phi$ Bore	使用螺丝 Bolt	重量 Weight
N309A	6.5	M6	0.025kg

**N308B Hinges**

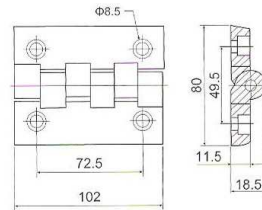

编号 Code	孔径 $\Phi$ Bore	使用螺丝 Bolt	重量 Weight
N308B	8.5	M8	0.100kg

**N307A Hinges**

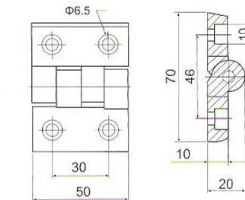

编号 Code	孔径 $\Phi$ Bore	使用螺丝 Bolt	重量 Weight
N307A	6.5	M6	0.050kg

**N301 Modular Transfer Roller Plates**

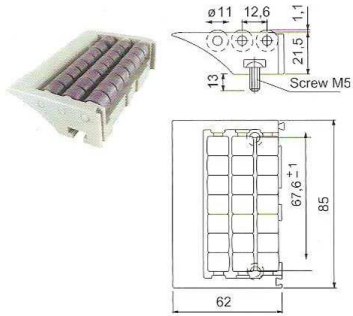

Material: POM + SS Pin

**N302 Modular Transfer Roller Plates**

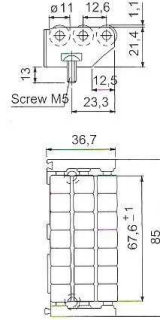

Material: POM + SS Pin

**N303 Modular Transfer Roller Plates**

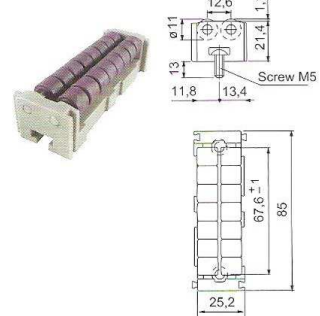

Material: POM + SS Pin

**N401**

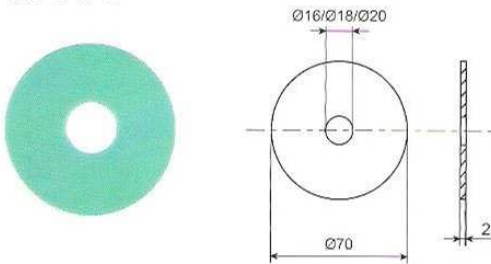

**N403**

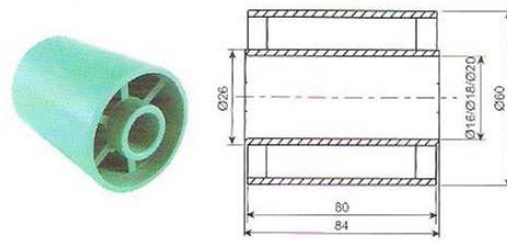

**N406**

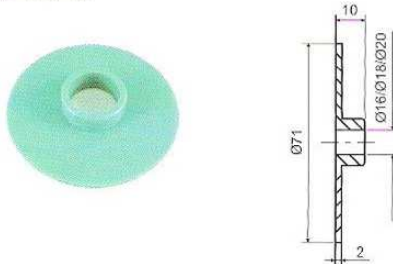

**N405**

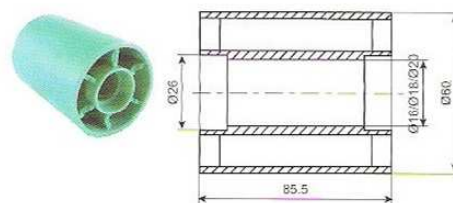



**Wear Strip Shoe**

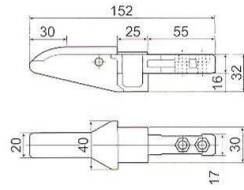
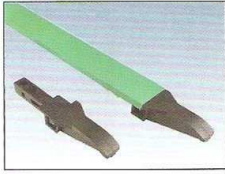

编号 Code	应用 Application	重量 Weight
W614-S	用于衔接惰轮和垫轨 Shoes are used to help chain guide between idler wheels and wear strips.	0.061kg

Material: Reinforced Polyamide with SS Setscrews.

**N255 Chain Tensioners**

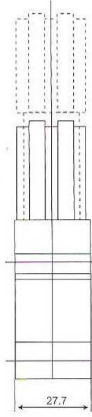
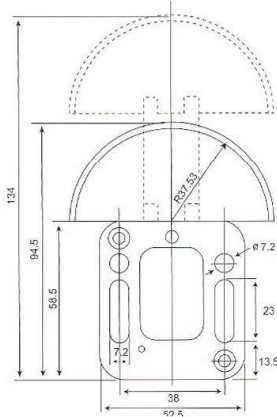

编号 Code	链条 Chain No.	T
N255-12B1	12B-1	25

Material: Reinforced Polyamide with SS Setscrews.

**Round Cap Side Guide**

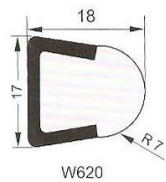

3m/pc

编号 Code	U型钢 U Profile	耐磨条 Wear Strips	重量 Weight
W620	SUS 304	HDPE	1.665kg
			1.670kg

**Flexa Side Guide**

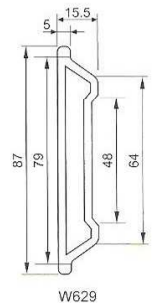

3m/pc

编号 Code	材质 Material	颜色 Colour	重量 Weight
W629	HDPE	黑色 Black	1.710kg

N316-2 Duplex Roller Side Guide (Sideflexing)

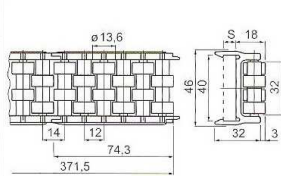
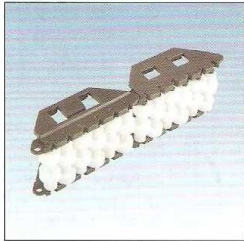

Material: Polyamide + POM

N316-4 Quadruplicate Roller Side Guide (Sideflexing)

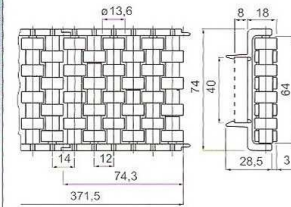
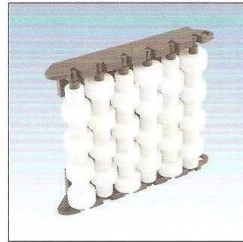

Material: Polyamide + POM

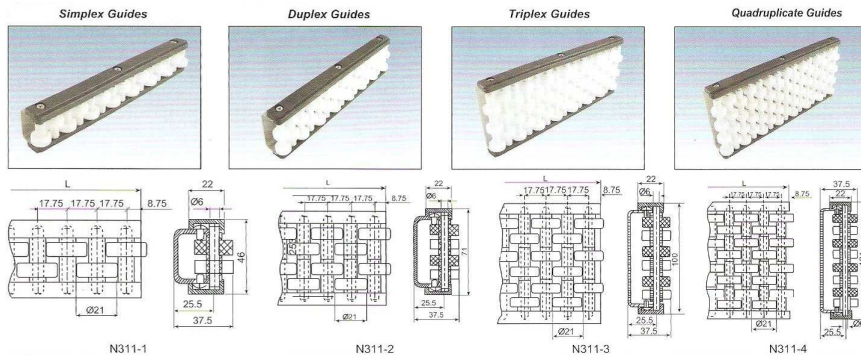

编号 Code	品名 Description	重量 Weight	滚珠 Roller	轴心 Pin	C型槽板 C-Profile	黑色护套 Straps	特点 Feature
N311-1	单排算盘护栏 Simplex Guides	2.55kg/m	白色 POM White POM	不锈钢 SUS 304	不锈钢 SUS 304	增强尼龙 Reinforced Polyamide	1. 低噪音 2. 耐摩擦 3. 使用寿命长 4. 易安装 ● Low Noise Rollers ● Excellent for Accumulation Areas ● Long Life and Smooth Operation ● Easy and Quick Installation
N311-2	双排算盘护栏 Duplex Guides	3.72kg/m					
N311-3	三排算盘护栏 Triplex Guides	5.00kg/m					
N311-4	四排算盘护栏 Quadruplicate Guides	6.20kg/m					

也可选用POM轴心  
POM is also available.

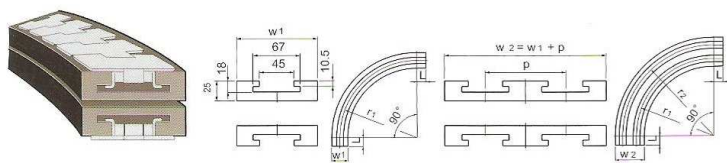
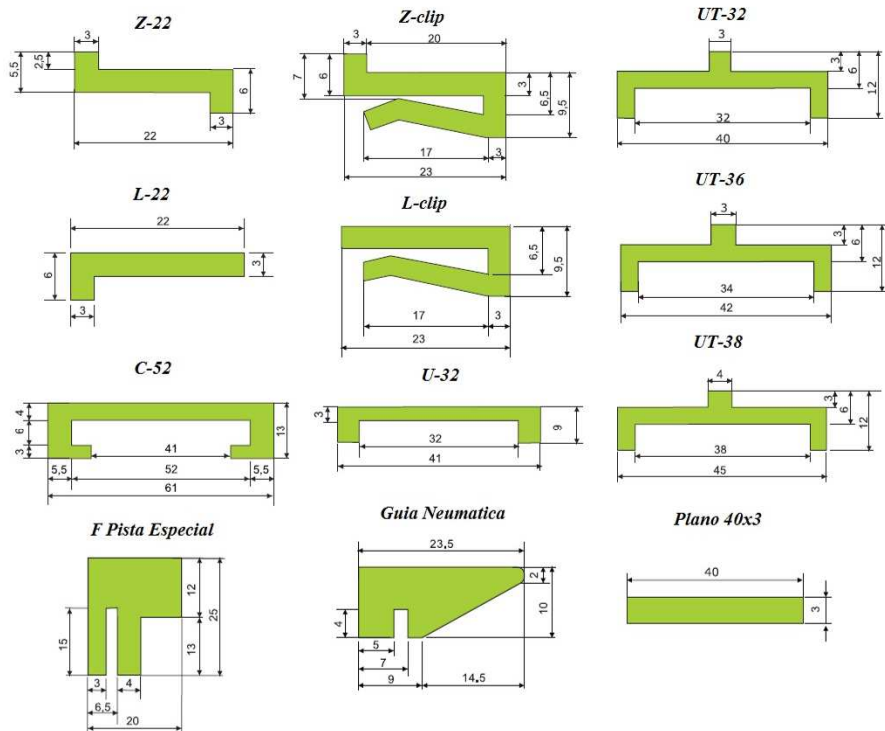

FOR Series 878TAB, 880BS, 880TAB, 881TAB

链板型号 Used for Chain Type	链板宽度 Chain width mm	转弯半径 Radius r1 mm	导轨宽度 Width w1 mm	切线长 L mm	间距 Pitch p mm
K325	82.5	500	100	50	90

CORNER TRACKS

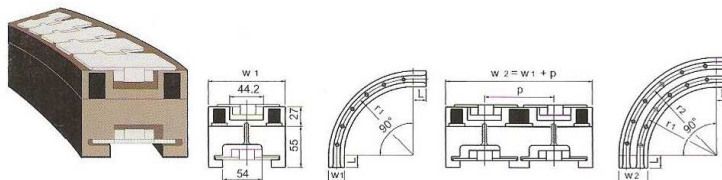

FOR Series 881M

链板型号 Used for Chain Type	链板宽度 Chain width mm	转弯半径 Radius r1 mm	导轨宽度 Width w1 mm	切线长 L mm	间距 Pitch p mm
K325	82.5	500	100	125	90

MAGNETIC CORNER TRACKS

**SUCFPL Series Plastic Housing With Stainless Steel Bearing**

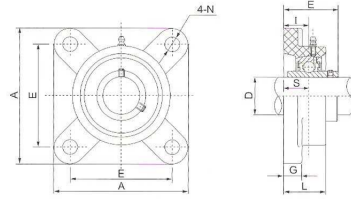

带座轴承型号 Bearing Unit No.	轴径 Bore Dia (mm)	A	E	I	G	L	N	E	S	轴承 Bearing No.	轴承座 Housing No.	重量 Weight (kg)
SUCFPL 204	20	86	63.5	16.3	13.4	27.8	11	34.6	12.7	SUC204	FPL204	0.28
SUCFPL 205	25	95	70	17	14.3	28.5	11	36.8	14.3	SUC205	FPL205	0.34
SUCFPL 206	30	107	83	19	14.3	31.5	11	41.2	15.9	SUC206	FPL206	0.49
SUCFPL 207	35	118	92	21.5	15.5	34.5	13	46.9	17.5	SUC207	FPL207	0.71
SUCFPL 208	40	130	102	23	17	36.5	14	53.2	19.0	SUC208	FPL208	0.99

**SUCFLPL Series Plastic Housing With Stainless Steel Bearing**

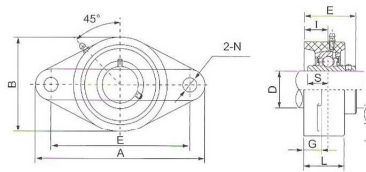

带座轴承型号 Bearing Unit No.	轴径 Bore Dia (mm)	A	E	I	b	G	L	N	E	S	轴承 Bearing No.	轴承座 Housing No.	重量 Weight (kg)
SUCFLPL 204	20	113	90	15	6.5	13.4	26.5	11	33.3	12.7	SUC204	FLPL204	0.24
SUCFLPL 205	25	131	99	16.5	7.0	14.3	28	11	36.3	14.3	SUC205	FLPL205	0.54
SUCFLPL 206	30	148	117	18	8.0	14.3	30.5	11	40.2	15.9	SUC206	FLPL206	0.64

**Female Threaded Spindle**

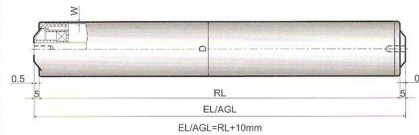

Please Indicate Roller Length RL When Ordering.

外管材质 Tube Material	管径及管厚 Tube Dia. x Tube Thickness DxW (mm)	轴心外径 Spindle Dia. mm	型号 Type
不锈钢 Stainless steel	50 x 1.5	Ø12 - M8 x 15	FCS 5015 - 12

**Spring Loaded Spindle**

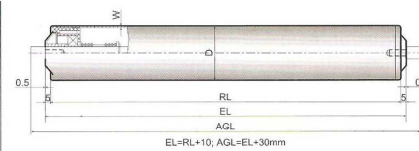
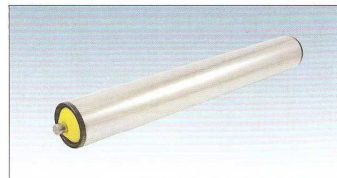

Please Indicate Roller Length RL When Ordering.

外管材质 Tube Material	管径及管厚 Tube Dia. x Tube Thickness DxW (mm)	轴心外径 Spindle Dia. mm	型号 Type
不锈钢 Stainless steel	50 x 1.5	Ø12	FSS 5015 - 12



